

# LEROI H11-H111 SCHRAMM D55 HAND SINKER

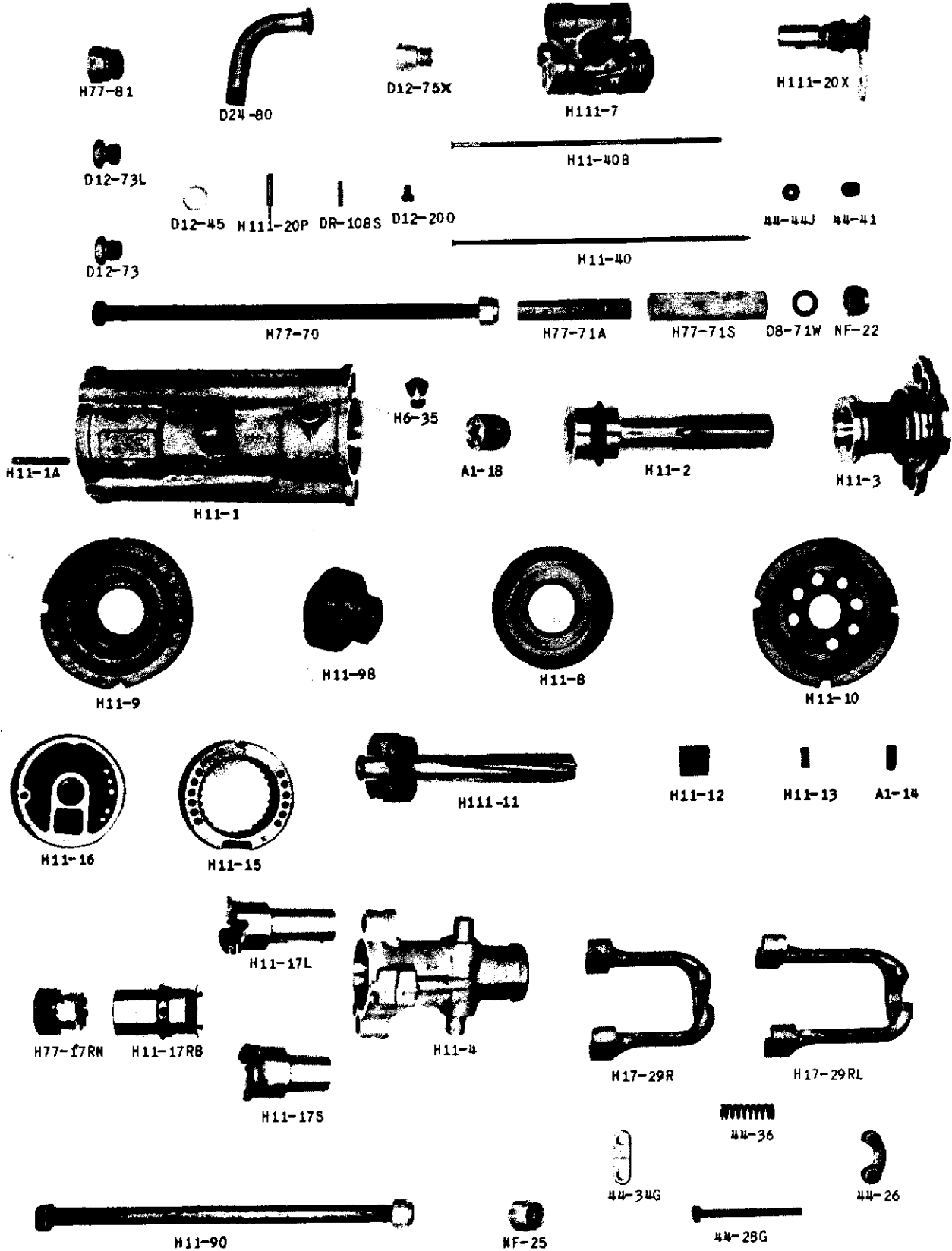

# LEROI H11-H111 SCHRAMM D55 HAND SINKER

NEW PART NUMBER	OLD PART NUMBER	REF. NO.	NAME OF PART	NEW PART NUMBER	OLD PART NUMBER	REF. NO.	NAME OF PART
<b>BACKHEAD</b>				<b>VALVE, ROTATION</b>			
8-524	H111-20P	1940	Detent Plunger	19-519	H6-35	1951	Oil Plug
19-508	D12-20Q	1942	Detent Plug	53-655-4	A1-18E	1987	Rifle Nut
55-2008-4	H10-40B	1914	Blow Tube	8-527	H11-2	1984	Piston
125-418	44-41	171 *	Tube Packing	216-104-2	H111-11B	1989	Rifle Bar
20-1008	44-44J	1950	Tube Washer	216-104-4	H111-11E	1988	Rifle Bar
16-2008	D12-45	1948	Gland & Spud Gasket	38-825	H11-16	1789	Bearing Plate
A65-2205	D12-75X	1975	Spud Incl. D12-75, D7-78P, D7-78S, D7-79	67-107	H11-12	1788	Pawl
125-419	D7-78P	1976	Spud Packing	24-1005	H11-13	157	Pawl Spring
43-602	D7-79	1962	Spud Screen	8-516	A1-14	158	Pawl Plunger
65-2214	D24-80	998	Air Swivel	<b>CHUCK, SIDE ROD, RETAINER</b>			
A53-643	H77-81	997	Swivel Nut Incl. 1937	53-644	H77-17RN	991	Chuck Nut Threaded
125-417	H77-81R	1937	Swivel Nut "O" Ring	213-123	H11-17L-1	989	1" Hex 4¼" Chuck
24-1017	DR108S	1941	Detent Spring	213-121	H11-17L	1397	¾" 4¼" Chuck
	H77-70	2901	Handle Bolt	213-141	H11-17L	1915	1" Q.O. 4¼" Chuck
	H77-71A	2902	Grip Tube	213-119	H11-17S	952	¾" Hex 3¼" Chuck
	H77-71S	2903	Grip	24-1021	44-36	1000	Retainer Spring
M-16-6	M16-6	1938	Air Connection Gasket	53-646	NF-25	954	Side Rod Nut
62-KB	HP-9	1902	¾" Pipe ½" Hose Nipple				
15-1039	44-80	1901	Water Valve				

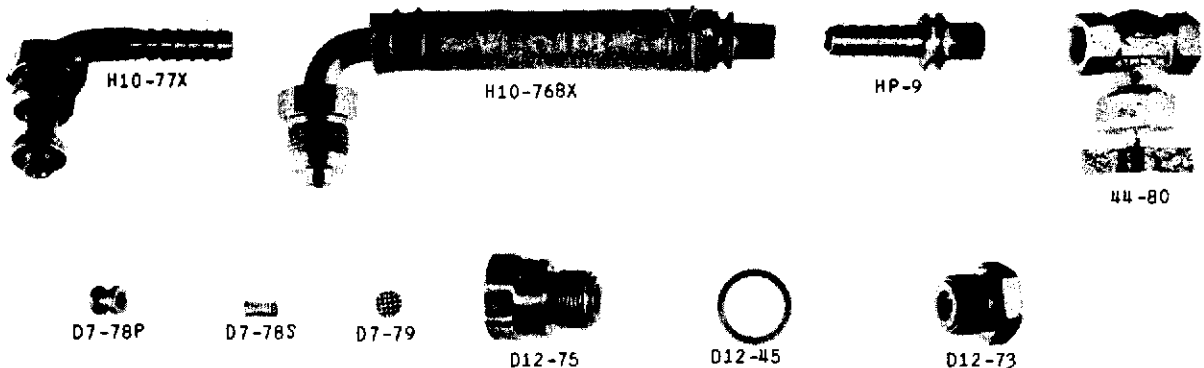

For Parts Call Tools Renewed (800) 247-3639 Fax (860) 665-9821