



MODEL 4020 PAVING BREAKER



40 / 45 LB. CLASS

MODEL 4020 - 1" x 4-1/4" HEX CHUCK
 (Does not have Built-In Oil Reservoir)
 (External Lubricator Recommended)

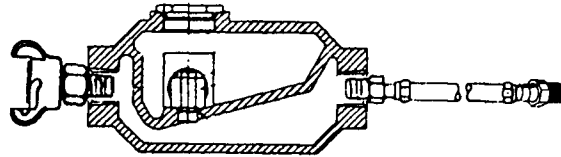

WHIP HOSE/LUBRICATOR ASSY.
 9095-4 Hose, 9371 Lubricator
 (Hose 1/2" I/D X 10 Foot)

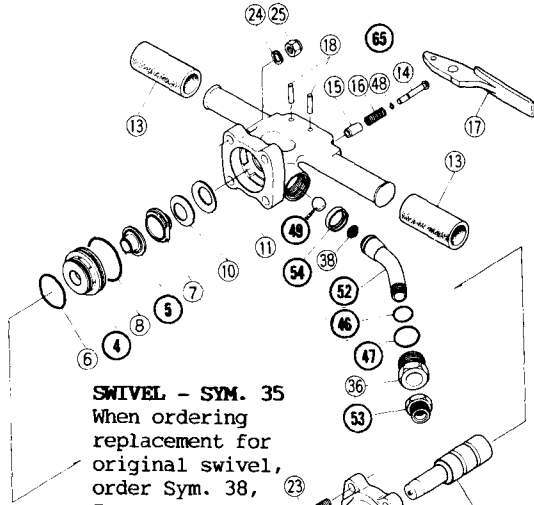

SWIVEL - SYM. 35
 When ordering for replacement for original swivel, order Sym. 38, Screen Assy.

OVERSIZE PISTONS Available in even increments
 +.002" to .020", P/N 66403+002, etc.

SYM. NO. 65, P/N 66465 - BACKHEAD, COMPLETE
 (Inc. 11, 13, 14, 15, 16, 17, 18, 36, 38, 46, 47, 48, 49, 52, 53 & 54)

SYM. NO. 69, P/N 66469 - FRONTHEAD COMPLETE
 (Includes 21, 28, 29, 30, 31, 32, 33, 34 & 55)

SYM. NO. 38, P/N 66438 - RETROFIT AIR SCREEN ASSEMBLY:
 If original air screen, an integral part of the swivel, has disintegrated with only traces left, the remainder should be removed. This screen is swedged into the end of the swivel with a slightly cupped flange, which is approximately 1/8" deep. This flange should be ground off flush with the major diameter of the swivel. The new surface should be reasonably flat and parallel. Wash the swivel in solvent or sudsy water to remove all grinding particles, etc. and blow out with compressed air. Remove Sym. 54, P/N 66454, a cupped spacer, and discard. Be certain to retain 3/4" Nylon ball in its socket. Replace Sym. 54 with flat washer furnished and install air screen disc on top of this new washer. Reinstall swivel and nut assembly with O/rings. It is a good practice to replace the O/rings, if the tool has been in service for a long period of time. Securely tighten swivel nut and test.

SYM. NO.	NAME OF PART DESCRIPTION	AMT RQD	PART NO.	SYM. NO.	NAME OF PART DESCRIPTION	AMT RQD	PART NO.
1	Cylinder, bare	1	66401	30	Nut, steel retainer bolt	1	66930
3	Piston (hammer)	1	66403	31	Lockwasher, steel retainer bolt	1	66931
4	Chest, automatic valve	1	66404	32	Bushing, rubber (EDM), retainer bolt	2	66932R
5	Valve, automatic	1	66405		Bushing, polyurethane, retainer bolt		66932P
6	O/ring, small O/D, auto.vlv.chest	1	66406		Bushing, steel (split),retainer bolt		66932S
7	Cover, automatic valve	1	66407	33	Plunger, steel retainer	1	66933
8	O/ring, large O/D, auto.vlv.chest	1	66408	34	Spring, steel retainer plunger	1	66934
10	Washers, spring disc,automatic vlv.	2	66410	36	Nut, air inlet swivel	1	66436
11	Backhead, bare (with bushing)	1	66411	38	Screen, air (kit), swivel assy.	1	66438
13	Grip, handle backhead, rubber	2	66913	39	Bolt, fronthead (pinch bolt)	1	66339
14	Pin, throttle valve push rod	1	66414	40	Nut, fronthead bolt	1	66340
15	Bushing, throttle valve pin	1	66415	44	Bushing, chuck 1" hx X4 1/2"	1	66444
16	Spring, throttle valve pin	1	66313	46	O/ring, air inlet swivel	1	66622
17	Lever, throttle	1	66917	47	O/ring, nut, air inlet swivel	1	66637
18	Pin, throttle lever	2	66918	48	O/ring, throttle valve pin	1	66448
21	Fronthead, bare (no chuck bushing)	1	66421	49	Valve, throttle (ball)	1	66449
23	Bolt, backhead	4	66323	52	Swivel, air inlet 1/2" NPTM	1	66635
24	Lockwasher, backhead bolt	4	66324	53	Adapter, swivel, 1/2" NPTF x 3/4" NPTM	1	66453
25	Nut, backhead bolt	4	66325	54	Spacer,retainer,cupped, throttle ball	1	66454
28	Retainer, steel (latch)	1	66928	55	Washer, flat, 66932 bushing cover	1	67545
29	Bolt, steel retainer	1	66929	65	Backhead, complete		66465
				69	Fronthead, complete w/retainer assy.		66469

WHEN ORDERING PARTS, PLEASE SPECIFY MAKE, MODEL, PART NUMBER AND PART DESCRIPTION.